

Every year I'm on the hunt for a new project to make quick and easy holiday gifts for family, teachers, friends and others! I try to keep the cost down on these projects to as little as possible, since it seems the list of who to make it for grows larger and larger each year! I also try to find projects that my children can easily participate in it with me, so it truly can be a gift from them! This year, I found a new tool that I thought would make a great holiday project! And talk about CHEAP!! 😊 These little stained glass ornaments look great hanging from a window, or hanging from the holiday tree! You can make them for birthdays, thinking of you, and many other times of the year!

Materials Needed:

- [Vinyl](#) (prefer black, but any color will do!)
- Acetate (heavy duty works better, such as those for Laser Printers)
- [Transfer Tape](#)
- [Die Cut Machine](#)
- Stained Glass Pattern ([DOWNLOAD HERE](#))
- [Glaze](#) Gelly Roll™ or Soufflé Gelly Roll™

1. Choose your stained glass pattern. There are several free patterns on the web, if you do a search for them! One of my favorite sites is [Chantal's Stained Glass](#) patterns. The pattern included in this project is one of her designs, and was created into a cutting file and used with her written permission!

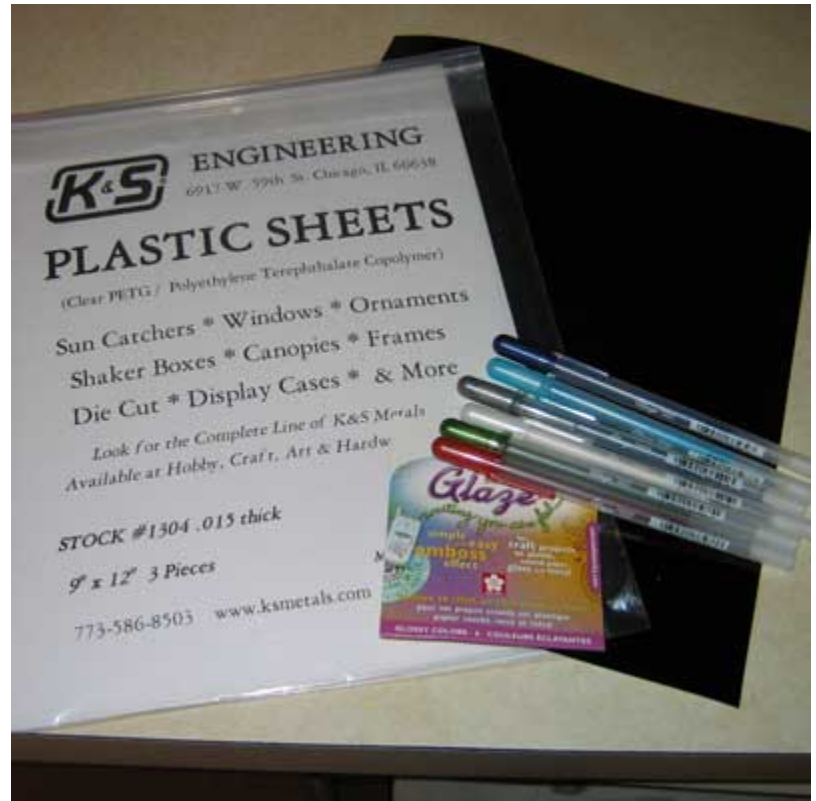

2. Once you have your pattern chosen, you will need to use whatever method needed to create the cut lines. For this pattern, I first brought it into my graphics program, so that I could thicken the lines a little bit. Then I took that enhanced image into my cutting program and did an auto trace of the lines. In this case, you want the “double” line trace, and not the centerline trace of the image. Make sure you also take your outer line and “expand” it to make a second outer line that is slightly larger than your actual cutout of the pattern. This will be the line that you use for your transparency, which you want to be about 1/32” wider than the cut. (See purple line in the supplied pattern!) [DOWNLOAD THE COMPLETED PATTERN HERE!](#)

3. With your pattern traced and opened in your cutting program, I recommend that you size it to about 4” x 4” square. Then, load your transparency sheet into your cutter and cut the purple line. Then, loading your vinyl, cut the black lines (stained glass pattern.)

4. Take your cut piece of acetate, and clean it with Windex, WD-40, GOO Gone, or some other cleaner that will remove any left over residue from the acetate.



5. Then, taking your cut vinyl, remove all excess parts of the vinyl, until you are left with only your cut piece. Using the transfer tape, layer it over the top of the whole cut piece. Turn it upside down and take your pen cap or other tool and burnish the tape down, to allow the vinyl to adhere well to it.

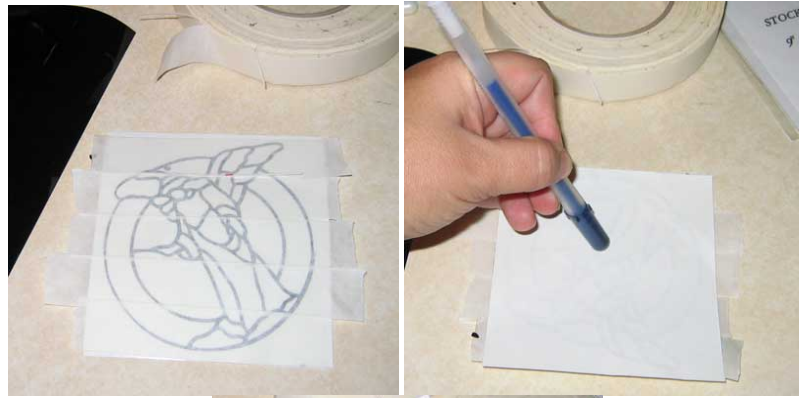

6. Slowly peel the backing of the vinyl off. Leaving you with the cut piece on the transfer tape.



7. Take your cleaned acetate piece, and very carefully line it up over the cut vinyl piece, then gently pressing it down.

8. Turn the whole piece over, and again using your pen cap or other burnishing tool and rub over the surface of the transfer tape. This will allow it to transfer over to your piece of acetate (kind of like a rub on!) You don't have to rub hard, just gently rub across the transfer tape so your vinyl adheres to the surface.



9. Now, grab a corner/edge of your transfer tape and slowly lift it off of the material. It should easily peel away, leaving you with your vinyl adhered to your piece of acetate.

10. Now comes the fun part 😊 You get to now take your Glaze Gelly Roll pens or Soufflé Gelly Roll pens, and holding the pen perpendicular to your materials, slowly fill in your areas with the colors of your choice. Make sure that your material is on a flat surface, so that the ink doesn't "pool" into one

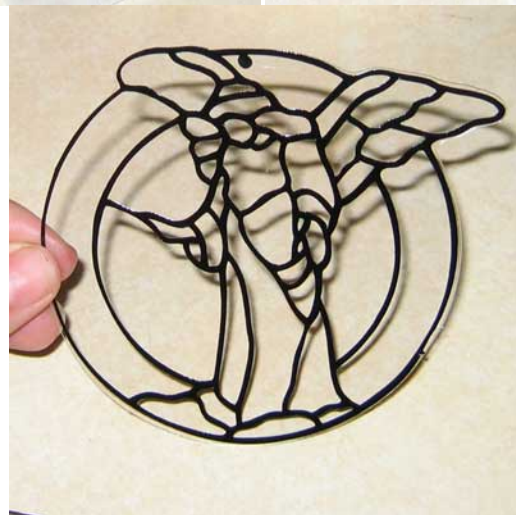

spot too much, and then just evenly fill in the surface until you get a nice even coating. You would continue this with each section of the design, until you completely fill in the design. Couple quick tips on this part are to make sure that you don't TOUCH the ink before it dries, keep the project flat, and let it dry a good 2 minutes between coats. You can then put a second coat in for a deeper color!

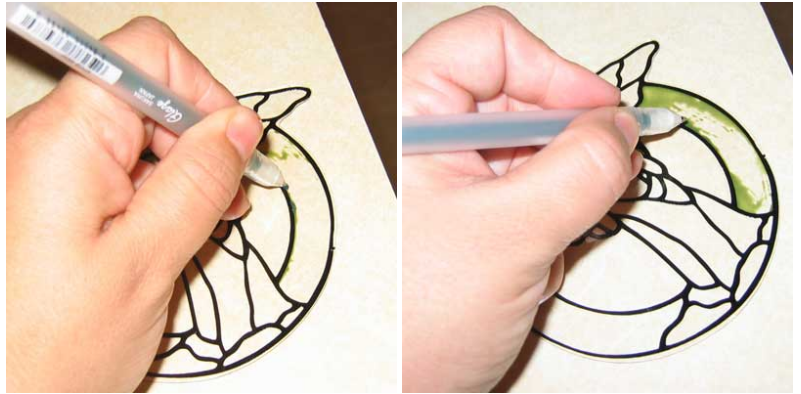

11. Once dry, then you can punch a small hole at the tope, and add a ribbon, tie it up and hang it in your window or on your tree!



Additional little hints and tips: Glaze and Soufflé pens can also be used intermixed for a great look! Use the glaze pens for your first layer, then the Soufflé pens for the additional layers! Make sure that you allow proper time to dry, and that you don't touch your project, or you will end up with "clumps" or finger prints! IF that happens, take your tweezers or even your fingernail, and gently scrape away your color from that section, then start over! Another great idea is doing this project on a mirror then hang the project, or do a full large design, breaking your design into several pieces, and "piecing" it together and hang onto your window! Have Fun!!